

GROUND FLOOR
APPROX. FLOOR
AREA 414 SQ. FT.
(38.5 SQ. M.)

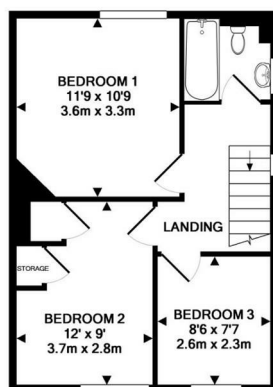

1ST FLOOR
APPROX. FLOOR
AREA 382 SQ. FT.
(35.5 SQ. M.)



2 Church Lane Cottages Church Lane, Doddinghurst, Brentwood, CM15 0NJ

A 1920's built character cottage with three bedrooms, excellent off street parking and a large rear garden which measures in excess of 250, dog owners will find that the garden is dog friendly with plenty of space and is very secure. The property has multi fuel burners in both the lounge and kitchen/diner, with fitted appliances in the kitchen and two very useful storage cupboards, one of which houses the gas boiler. To the first floor you will find a modern bathroom with shower over bath and three good-sized bedrooms. Doddinghurst village schools, both infant and junior, are just a short walk from the property, as are the main parade of local shops and the village pub.

Guide Price £430,000

SERVICES:

Local Authority: Brentwood
Council tax band:
Post code: CM15 0NJ

VIEWING:

Strictly by prior arrangement with Keith Ashton Estate Agents

OPENING HOURS:

Monday to Friday: 8.45AM - 6.30PM | Saturdays: 9AM - 5.30PM | Sundays: 10AM - 2PM

MORTGAGE INFORMATION: We offer the additional facility of an in-house Independent Financial Adviser who will access all mortgage lenders with the purpose of providing you with the benefit of choice. For quotations or comparables please call 01277 375757 or visit our interactive website at www.mortgagebusiness.net

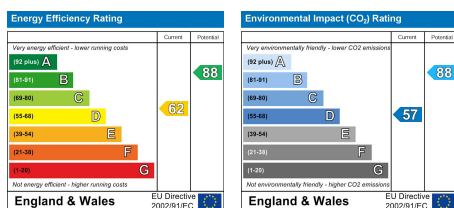

We the Agent have not tested any apparatus, fittings or services for this property. The plot size is intended merely as a guide and has not been officially measured or verified by the Agent. Photographs are for illustration only and may depict items which are not for sale or included in the sale of the property. As part of the service we offer we may recommend ancillary services to you which we believe may help you with your property transaction. We wish to make you aware, that should you decide to use these services we will receive a referral fee. For full and detailed information please visit 'terms and conditions' on our website www.keithashton.co.uk

Brentwood
Tel. 01277 260858

Village Office
Tel. 01277 375757

Lettings Office
Tel. 01277 202200

Explore more @ www.keithashton.co.uk

